



**SELVA & Co.**  
COMERCIAL

[www.selvacomercial.com](http://www.selvacomercial.com)



C. 20

C. 20

C. 20

# 28,232 m2 lot located in a growth area in Conkal, Mérida.

<i>ID: ALME203-2</i>	<i>Location: Mérida</i>
<i>Zone: Conkal</i>	<i>Type: Land</i>
<i>Land: 28,232 m2 / 303,889.25 ft</i>	<i>Land ha: 2.82 ha / 6.98 ac</i>



C-20

C-20

C-20



SELVA & Co.  
COMERCIAL

C-20

PARCELA 125

PARCELA 572

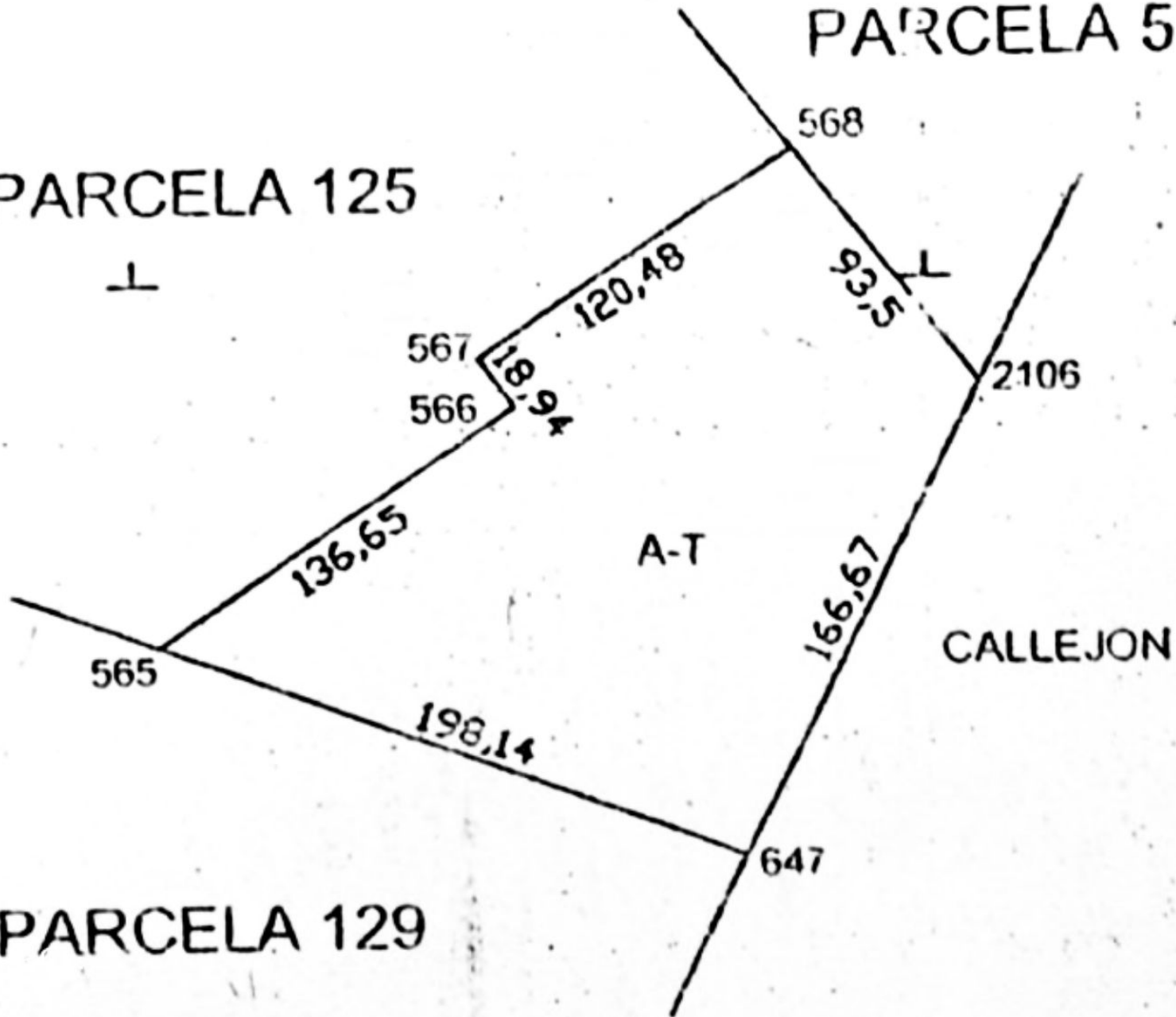



**Progreso**

**Chicxulub  
Puerto**



**A 30 minutos de Puerto progreso y Chicxulub puerto.**

**30 minutes from "Puerto Progreso" and "Chicxulub Puerto".**







## *Alrededores - Surroundings*



# Ayuntamiento de Conkal - *Conkal Town Hall*





**Mérida**

**"La isla" Mérida  
Shoppinmall**

**Yucatan  
Country Club**

**Cholul**

**Zona Arqueológica  
"Dzibilchaltún"**

**Conkal**



**TERRENO  
LOT**

**Chicxulub  
Pueblo**



## Description

ALME203-2 Andrea Llergo

28,232 m2 lot located in a growth area in Conkal, Mérida.

Investment opportunity in Conkal, located north of the metropolitan area of Mérida.

Developers land, on 20th street of the municipality of Conkal, which leads directly to the downtown area.

### INVESTMENT OPPORTUNITY

Conkal has experienced a notable increase in housing demand in recent years. This growth has led to the arrival of luxury residential developments, boosting commercial activity and generating a significant economic contribution. With its

transformation, Conkal has become an excellent option for investors and real estate developers seeking development opportunities.

## MEASUREMENTS

198.14 meters x 166.67 meters (irregular shape)

Total: 28,232 m<sup>2</sup>

## PROPERTY STATUS

Property title, legal certainty.

## LOCATION

Land for sale in Conkal, Yucatán, a growing area surrounded by new developments.

10 minutes from downtown Conkal

20 minutes from Yucatán Country Club (Golf Club)

25 minutes from Chicxulub Puerto and Puerto Progreso.

30 minutes from downtown Mérida

If you would like more information about the land or to learn more about the real estate market in the Conkal area, contact us, we will be happy to help you with your new investment in Yucatán.

The official price of this property is in pesos, the price in dollars is a reference. For the purchase, the exchange rate of the day will be used.

Schedule your appointment to visit the area or call us to resolve your doubts.

#Mérida    #Méridaproperties    #Conkal    #Méridalistings  
#selvacorealty    #Méridarealestate    #realestateMérida  
#selvacomercial    #commercialrealestateMérida  
#landbankingMérida    #landbankingMérida  
#lotsandlandMérida    #lotsforsaleMérida    #landforsale

#lotsforsaleConkal #macrolotsMérida

# Location

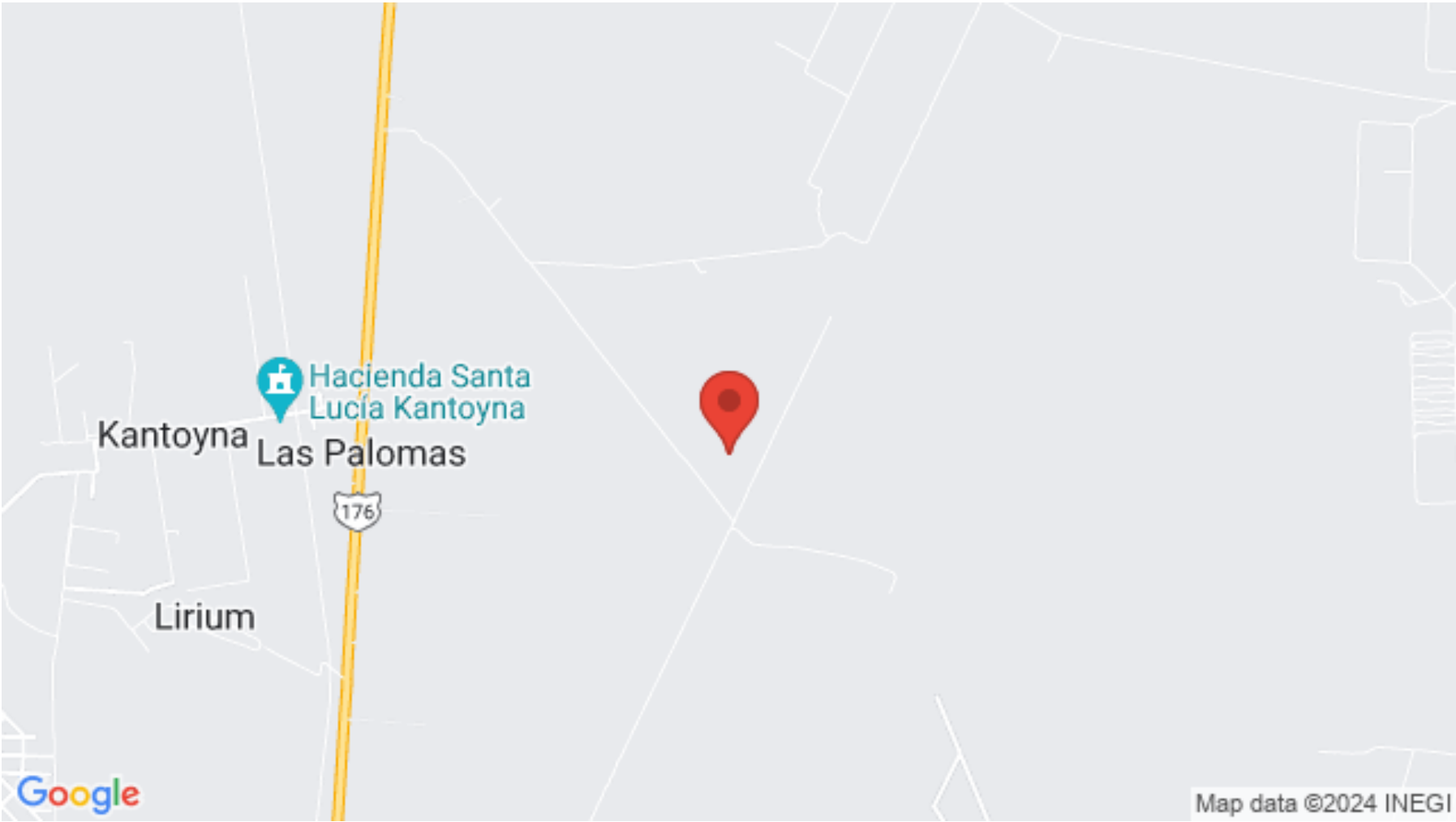



**SELVA & Co.**  
**COMERCIAL**

MX 984 803 2058 / US 805 308 2900  
[www.selvacomercial.com](http://www.selvacomercial.com)