



SELVA & Co.
COMERCIAL

www.selvacomercial.com



TULUM

MAR
CARIBE

ACEDIA ZAMA
IN COORDINACIÓN CON

Macrolot multifamily land permission to build 48 homes for sale in Aldea Zama, Tulum.

| | |
|--------------------------------------|-----------------------------------|
| <i>ID: MLS-DLTU204</i> | <i>Location: Tulum</i> |
| <i>Zone: Aldea Zama</i> | <i>Type: Land</i> |
| <i>Land: 5,000 m2 / 53,820.00 ft</i> | <i>Land ha: 0.50 ha / 1.24 ac</i> |
| <i>CUS: 1.7</i> | <i>COS: 0.6</i> |



TULUM

Carr. Coba-Mérida

Carr. Tulum-Cancun

MAR CARIBE

SELVA & Co.
AEDIA ZAMA

 SELVA & Co.
COMERCIAL

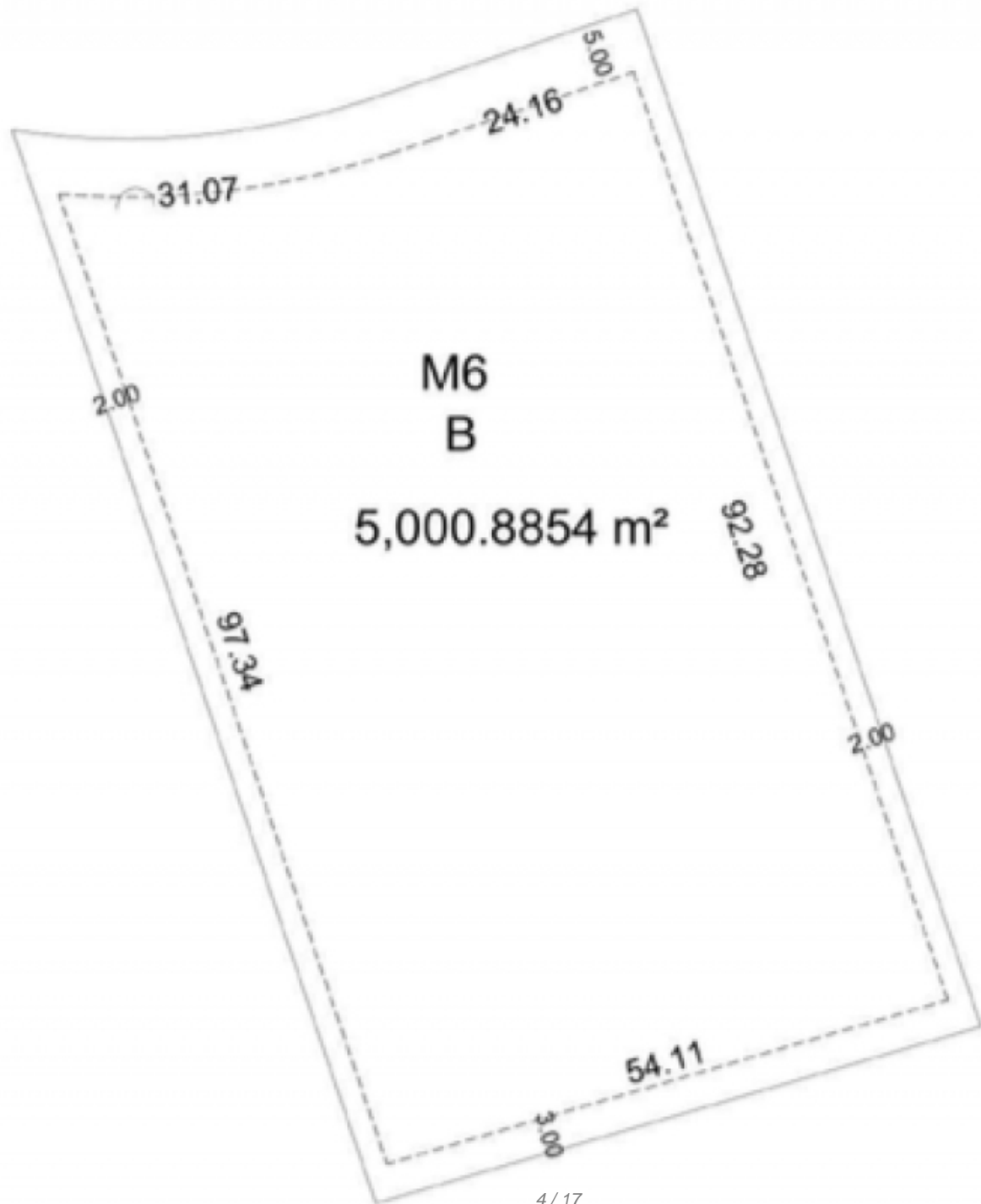



Area comercial
Commercial Zone





 SELVA & Co.
COMERCIAL





SELVA & Co.
COMERCIAL









 SELVA & Co.
COMERCIAL

12/17

Ciclopista a la playa /Aldea Zama bicycle path



SELVA & Co.
COMERCIAL

13717

Aldea Zama

Description

MLS-DLTU204

Macrolot, land for developer for sale Aldea Zama Tulum.

Located in Aldea Zama, the first planned community of Tulum, with underground services, green areas and bicycle path to the hotel zone and beach area, just 10 minutes by bicycle, you will not need a car. Aldea Zama also has a commercial area with restaurants, cafes and shops of original design.

Multifamily land for sale a few steps from the commercial zone of Aldea Zama.

Characteristics of multi-family land for sale:

Land use: residential

Maximum Height: 12 m

Max Levels: 3

Price per m2: 450 USD

5,000 m2

COS: 0.60%

CUS: 1.70%

Assigned homes: 48

Total price: 2'250,400 USD

#aldeazama #lotforsale #landforinvestors #investinmexico #tulum #aldeazama

Location





SELVA & Co.
COMERCIAL

MX 984 803 2058 / US 805 308 2900
www.selvacomercial.com